



#### FEATURES

- 14V LED Or Bright Incandescent Bulb
- Custom colors & printing available upon request

#### MOUNTING

No hardware or tools needed. Self locks into proper panel cutout 14.0mm (.550") x 28.6mm (1.125").

Acceptable panel thickness range is from .64mm (0.025") to 4.57mm (0.180").



**CAUTION!** Burr direction must be away from the direction of insertion

#### APPROVALS

RoHS compliant

#### SWITCH SELECTION CHART

Part No.	Description	Special Markings	BLK	WHT	RED	BLU	GRN	AMB	BRN	IVY
1Z-02-U	14V LED		○			○				
1Z-03-U	14V LED		○		○					
1Z-04-U	14V LED		○					○		
1Z-05-U	14V LED		○				○			
1Z-06-U	14V Bulb				○				○	
1Z-07-U	14V Bulb							○	○	
1Z-09-U	14V Bulb				○					○
1Z-10-U	12V Bulb							○		○
1Z-12-U	14V LED			○	○					

#### 1U SERIES (1Z-03-U SHOWN FOR REFERENCE PURPOSE ONLY)

##### ILLUMINATED WIRING DIAGRAM

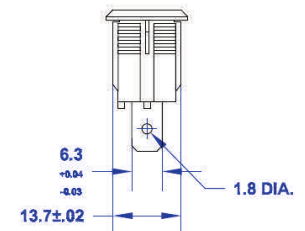
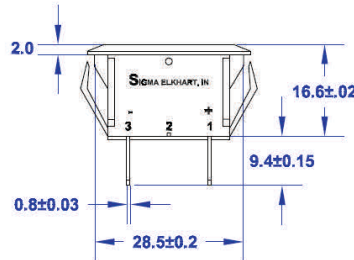
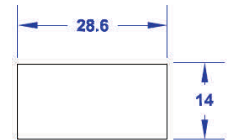
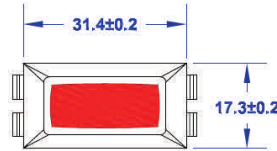
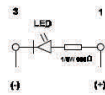

NOTE: CUTOUT SIZE IS FOR REFERENCE ONLY AND MAY VARY DEPENDING ON THE THICKNESS OF THE MATERIAL USED.



# SIGMA

## SWITCHES PLUS

4703 Wyland Dr.  
Elkhart, IN 46516  
PH: 574-294-5776  
FX: 574-294-8744

[www.sigmaswitches.com](http://www.sigmaswitches.com)

#### OUR COMMITMENT TO YOU

We are constantly adding-to and improving our selection of Rocker, Toggle, Push Button and other types of switches. If you do not find what you need here, or on other pages of our web site, please do not hesitate to contact us. If your need is custom, we would like to discuss your unique design requirements as well.

*Thank you for giving us the opportunity to fulfill Your switching needs!*